

PROPERTY DESCRIPTION

The Holman Office tower is an historical building located within the Confederation Court Complex. The building is connected to the Confederation Court Mall. The building's only other tenant is the Holman International Business Centre.

Old wooden beams give the space character and beautiful hardwood floors lay underneath the carpet. It features a small kitchen area as well as access to an outside patio. This space is accessible through the 3rd floor of the Confederation Court Mall, down the hall from The Montessori School of Charlottetown.

Holman Office Tower

134 Kent St, Charlottetown PE

FURTHER DETAILS

Offices :	4
Property Type :	Office
View :	City
Square Footage :	2772
Floor:	3

ADDRESS MAP

Postal Code :	C1A 8R8
No of Floors :	4
Longitude :	W64 52' 18.4"
Latitude :	N46 14' 8.5"

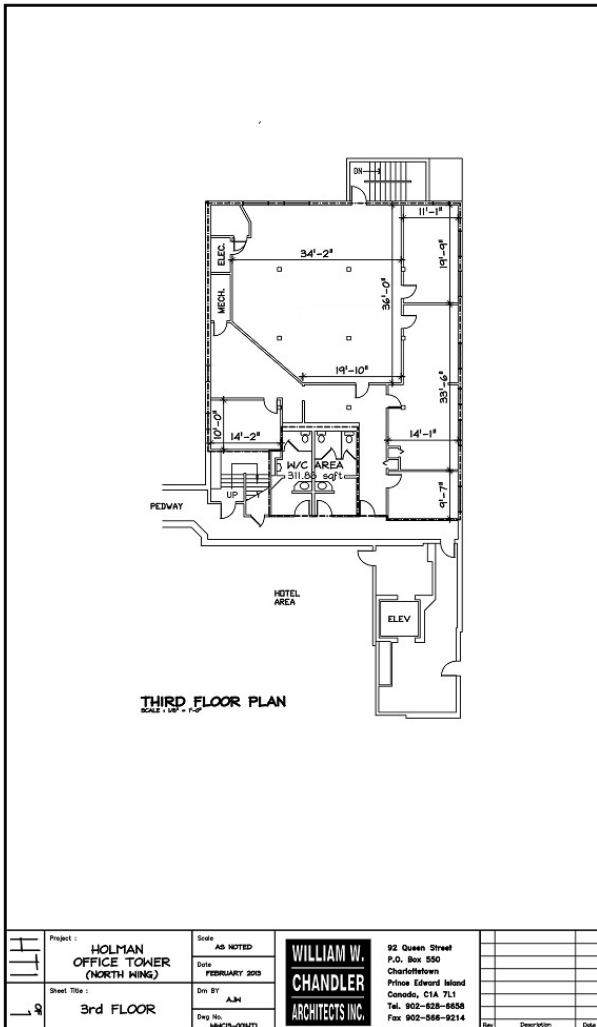

FOR MORE INFORMATION OR TO BOOK A VIEWING

902-566-1153
leasing@dyneholdings.com
 98 Fitzroy St, Suite 100
 Charlottetown, PE C1A 1R6

DYNEHOLDINGS.COM